

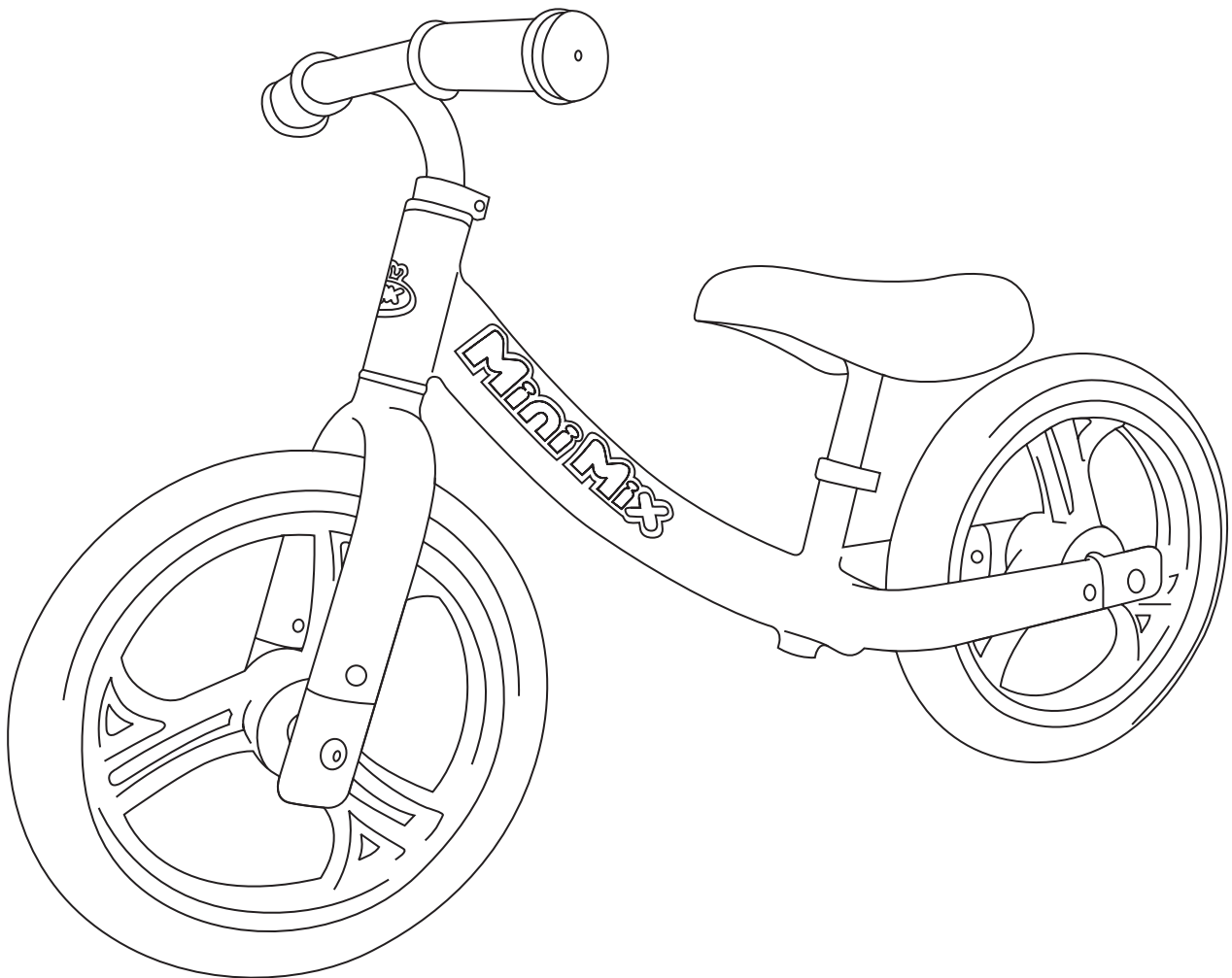

## INSTRUCTION MANUAL



PLEASE READ AND UNDERSTAND THE ENTIRE MANUAL THOROUGHLY BEFORE  
ALLOWING YOUR CHILD TO USE THIS PRODUCT.



APPROPRIATE AGE: 18 MONTHS TO 3 YEARS  
MAXIMUM RIDER WEIGHT: 34 KG / 75 LBS



**MARQUE LLC**

14271 Jeffrey Road, #508, Irvine, CA 92620 U.S.A  
Toll free number +1 (800) 282 - 7017

**[www.MinMixBikes.com](http://www.MinMixBikes.com)**

## REGISTRATION

To register your Mini Mix, you will need serial number located on the label underneath the frame. Your Mini Mix balance bike must be registered to activate warranty. Go to [www.MinimixBikes.com/register](http://www.MinimixBikes.com/register).

## WARRANTY

Your Mini Mix are warranted to be free from manufacturing defects for 2 YEARS, from the date of the original purchase. The warranty applies only to the original owner.

For warranty information: [www.MinimixBikes.com/warranty](http://www.MinimixBikes.com/warranty).

### **WARNING**

#### TO AVOID SERIOUS INJURY

- CONTINUOUS ADULT SUPERVISION IS REQUIRED.
- NEVER USE NEAR MOTOR VEHICLES, STREETS, SWIMMING POOLS, HILLS, STEPS, OR SLOPED DRIVEWAYS.
- KEEP AWAY FROM RIVERS, CLIFFS, DITCHES AND OTHER POTENTIAL DANGEROUS PLACES WHILE RIDING.
- RIDER SHOULD ALWAYS WEAR SHOES, A PROPERLY FITTED HELMET AND OTHER PROTECTIVE EQUIPMENT.
- ONE RIDER PER BIKE ONLY, CARRYING ANY OTHER PERSONS OR PETS IS PROHIBITED.
- THIS BIKE HAS NO BRAKES. RIDERS MUST STOP WITH THEIR FEET. THE RIDER SHOULD NOT RIDE FASTER THAN HE OR SHE CAN STOP SAFELY AND CONTROLLABLY.

## UNPACKING YOUR MINI MIX

### **WARNING**

- ADULT ASSEMBLY IS REQUIRED FOR THIS PRODUCT.
- THIS PACKAGE CONTAINS SMALL PARTS WHICH CAN BE CHOKING HAZARDS. SOME PARTS MAY HAVE SHARP EDGES OR SHARP POINTS. KEEP SMALL PARTS AWAY FROM CHILDREN DURING ASSEMBLY.
- DO NOT ALLOW CHILDREN TO PLAY WITH ANY PACKAGING MATERIALS.

To ensure safe operation of your balance bike, please follow these instructions carefully. Keep these instructions for future reference.

1. Carefully remove all parts from the box and polybag.
2. Identify the parts (front wheel, fork / frame / rear wheel / saddle assembly, handlebar, 5mm Allen wrenches, screws, and documents [not shown]) with the pictures in Figure 1.
3. Discard all packaging materials properly.
4. Remove the plastic coverings from any areas of the product and discard also.

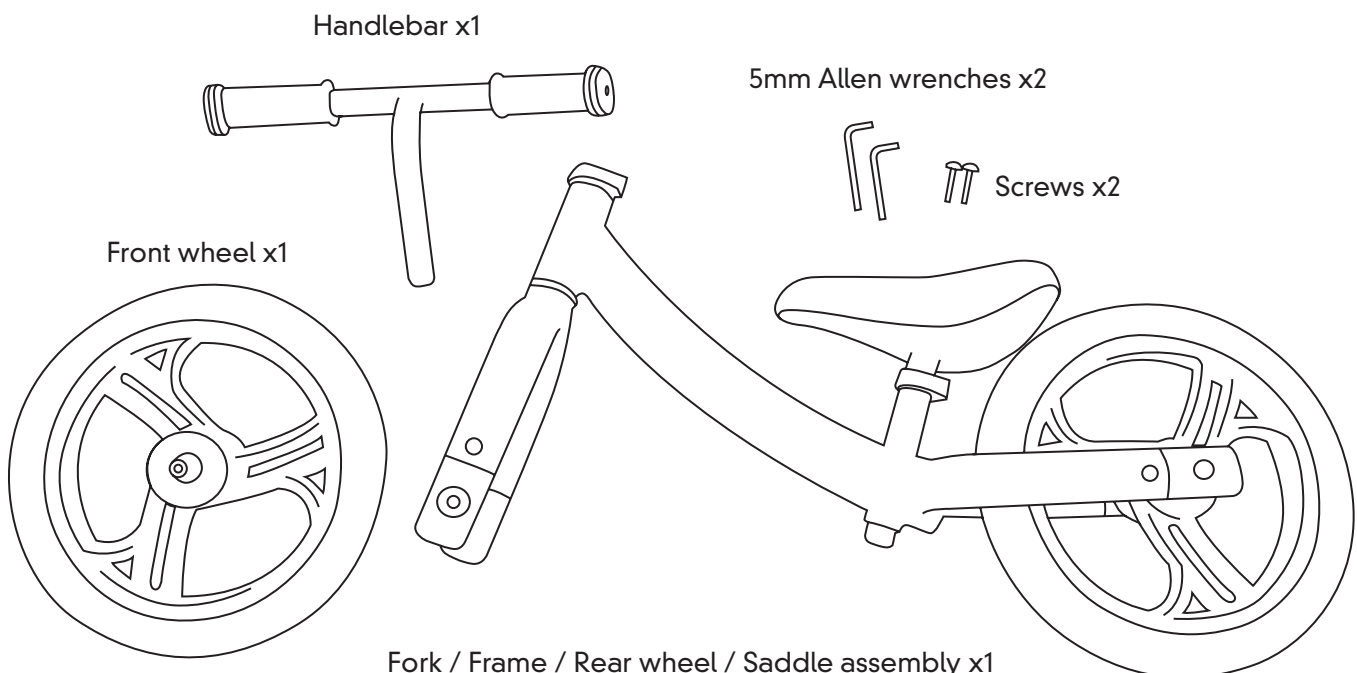

Figure 1

## ASSEMBLING THE HANDLEBAR AND FRONT WHEEL

KEEP CHILDREN AWAY WHILE ASSEMBLING

1. Use an Allen wrench to loosen the handlebar clamp. (See Figure 2)
2. With the clamp facing the back, insert the handlebar into the fork tube at the desired height. (See Figure 3 and 4) Note the minimum insert line on the handlebar tube.
3. Use an Allen wrench to tighten the binder clamp completely. (See Figure 5) The handlebar should be held firmly in place.
4. To fit the front wheel, turn the Mini Mix balance bike upside down so that it rests on the saddle and handlebar. Align the front wheel between the front fork ensuring that the wheel rotation direction matches the rear wheel. (See Figure 6)
5. Insert the screw into the hole on one side of the fork, and tighten it completely with a 5mm Allen wrench. (See Figure 7) Repeat it for the other side. Make sure screws are tightened securely.

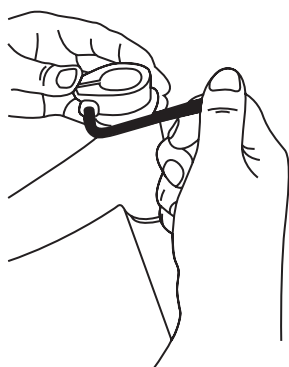

Figure 2



Figure 3

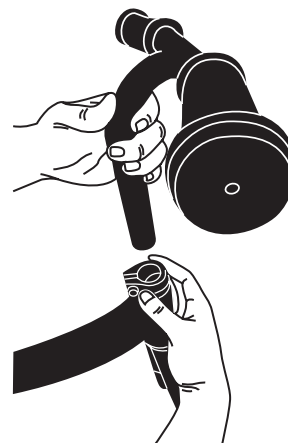

Figure 4

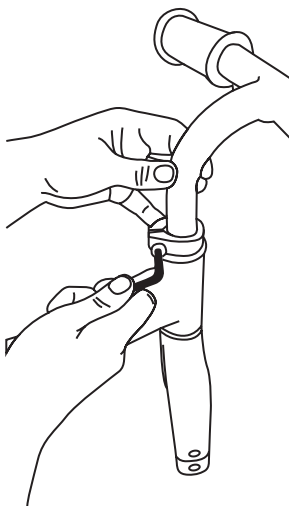

Figure 5

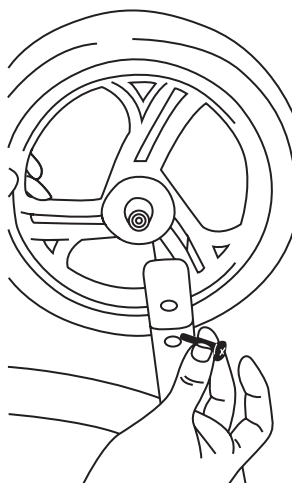

Figure 6

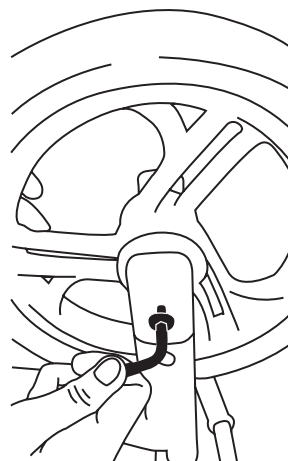

Figure 7

## ASSEMBLING THE SADDLE

Check for the correct saddle height by having your child sit on the saddle. Proper saddle height should allow your child to sit on the bike with both feet flat on the ground with a slight bend in their knees (See Figure 8). The correct saddle height is essential for proper functioning. Check and adjust the saddle height periodically.



Figure 8

1. Identify the seatpost clamp under the saddle and loosen binder clamp with the 5mm Allen wrench. (See Figure 9)
2. With the clamp facing the back, raise/lower the seat to the desired height. (See Figure 10 and 11)
3. Tighten binder clamp with the 5mm Allen wrench. (See Figure 12)
4. Push and pull on the saddle to make sure it is secured.

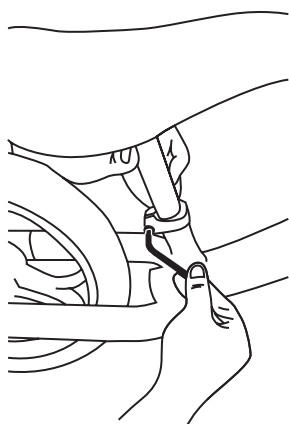

Figure 9



Figure 10

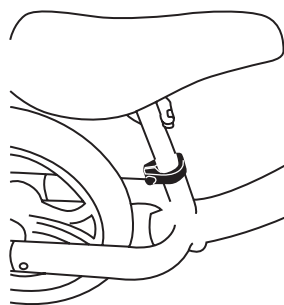

Figure 11

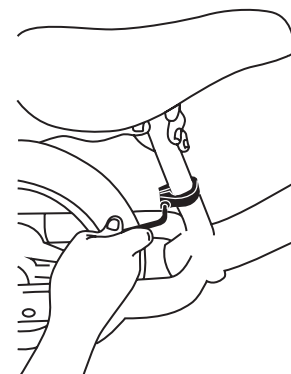

Figure 12

### CAUTION

MINIMUM INSERT LINE STAMPED ON HANDLEBAR TUBE AND SEAT POST MUST BE INSIDE THE FORK TUBE AND SEAT TUBE FOR PROPER INSTALLATION AND USE (SEE FIGURE 13).

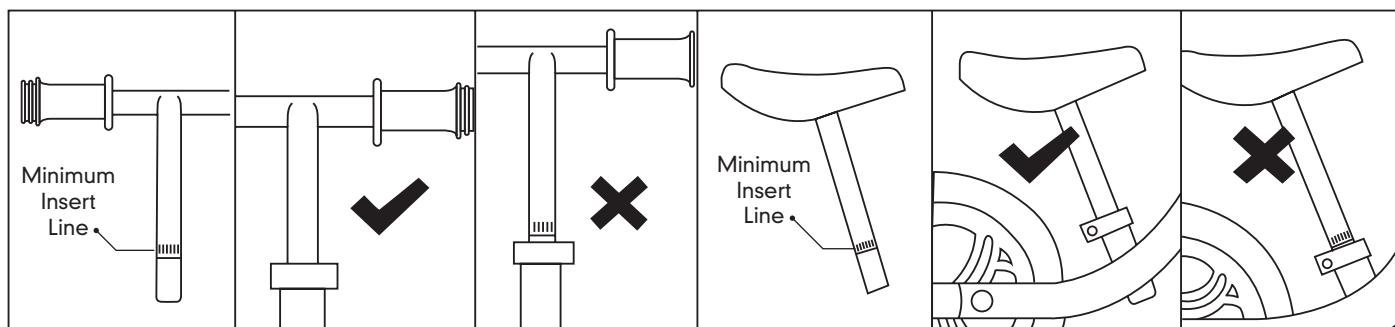

Figure 13

AFTER ADJUSTING THE SADDLE, MAKE SURE THE SADDLE DOES NOT TOUCH THE WHEEL (SEE FIGURE 14).

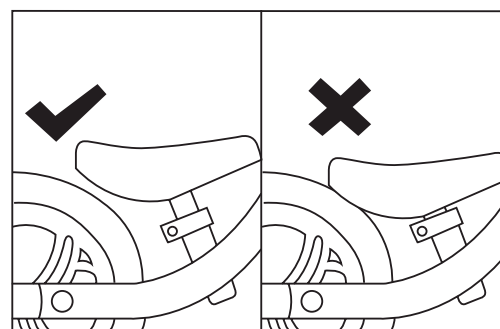

Figure 14

## MAINTENANCE

All of the screws, clamps, and other hardware and plastic parts on the balance bike should be inspected periodically to ensure that they are secured properly and not damaged or malfunctioning. All moving parts, such as wheels should also be checked periodically to ensure they are operating properly.

Any missing, broken, or worn components should be replaced immediately, and the balance bike should not be used until they are replaced. Only original manufacturer's components should be used. Do not begin any adjustments or service on your bike if you have any doubt about your ability to service the bike. Unauthorized or incorrect repairs may void product warranty. If needed, please email us at [info@minimixbikes.com](mailto:info@minimixbikes.com).

## CLEANING

The plastic and metal material on the balance bike can be cleaned using mild household soap or detergent and water on a sponge or clean cloth. Always allow to completely air dry before using the balance bike. The frame and wheels should always be kept clean and free of dirt and foreign matter. Use a sponge or cloth dampened with water and a mild household soap to clean the wheels after such use.